

MEDTEC AMBULANCE CORPORATION 574.534.2631 F 574.534.3629 2429 LINCOLN WAY EAST, GOSHEN, IN 46526-9292  
 AN OSHKOSH TRUCK CORPORATION COMPANY

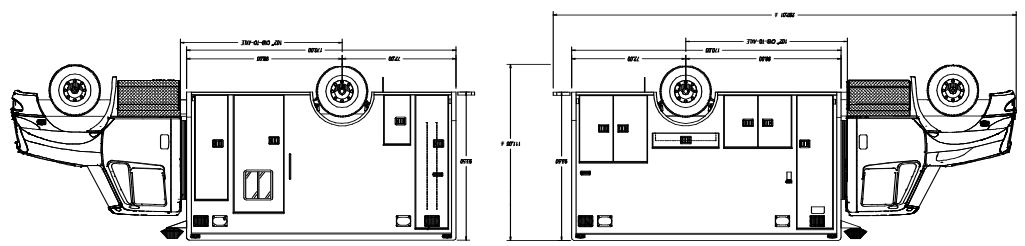

ADDITIONAL DUTY  
 TYPE I AD-170

www.medtecambulance.com

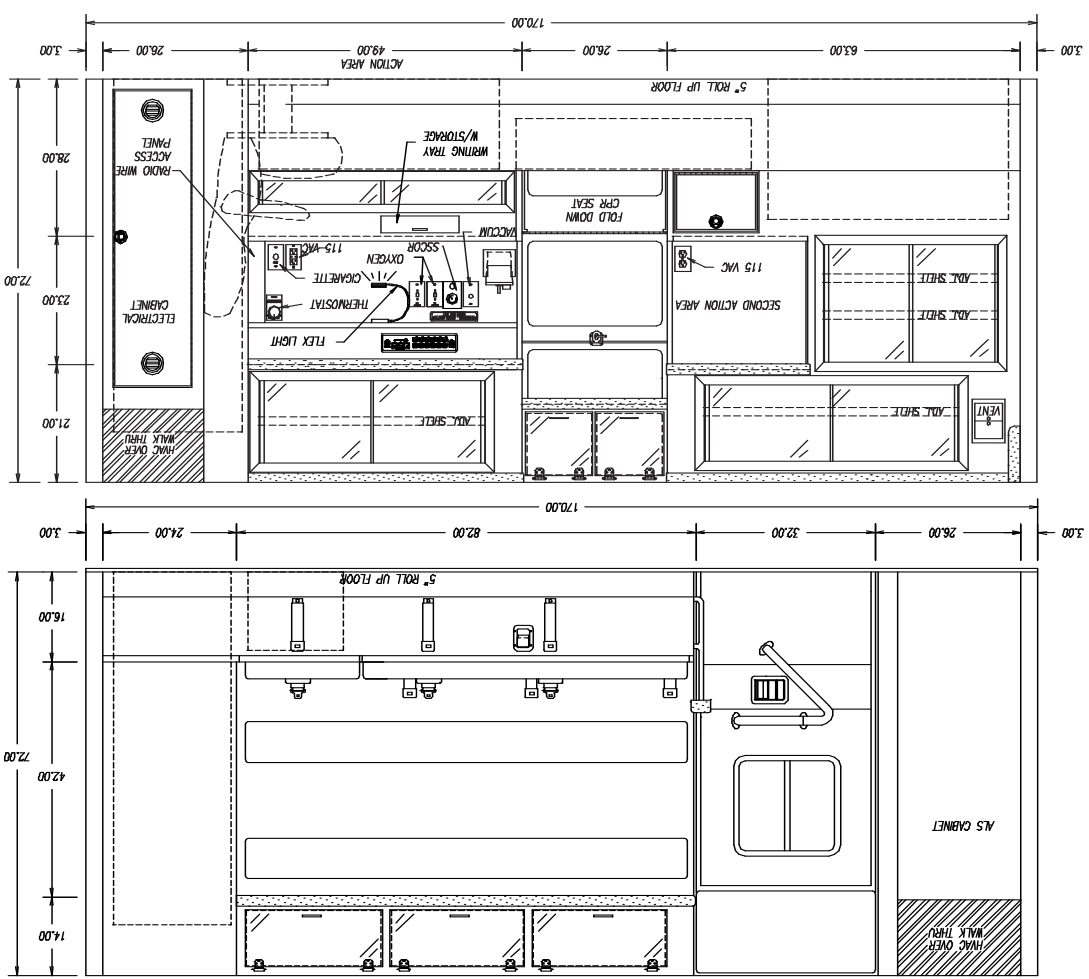
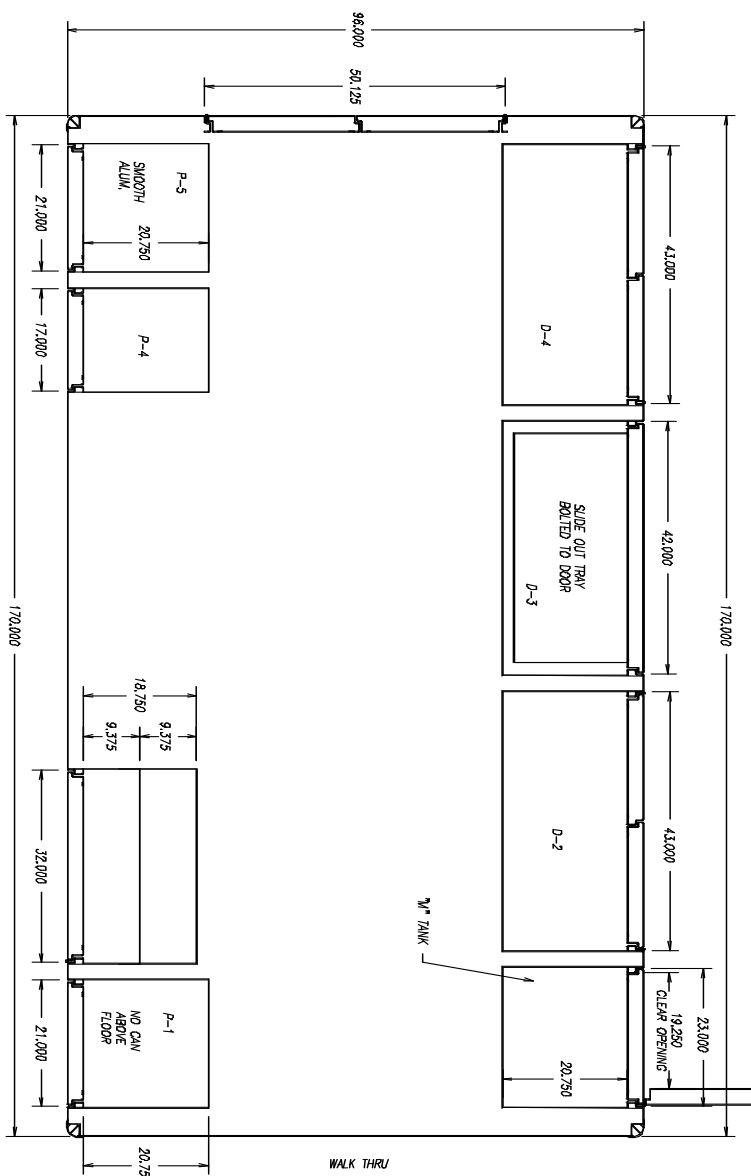

ADDITIONAL DUTY  
 TYPE I AD-170

# ADDITIONAL DUTY

## TYPE I AD-170

In a nutshell, AD-170 delivers long life, low maintenance, room to work and performance that rivals any ambulance you've ever seen. This ambulance gives you a full 72" of walk-around headroom, an easy-access medical control center and massive storage space.

The unitized body construction is structurally reinforced with cross members every 12" for added strength. The double-panel doors with double-point door latches increase strength, structural integrity, and stand up to years of difficult duty. In addition, the recessed liners and pressure sensitive seals keep your equipment cleaner by reducing the dirt and grime that gets into compartments.

The optional Command Zone™ Advanced Electronics and Multiplexing System helps you stay in control of every situation. Specifically engineered for Medtec® ambulances, Command Zone automatically checks electrical circuits, giving you real-time information about all ambulance functions, and full command of electrical loads. Plus, the built-in diagnostic software pinpoints problem areas within minutes, making maintenance more efficient than ever.

The box itself is designed to maximize your workspace and help make your job easier when you're on the road. Cabinets feature 5" rounded corners for safety during transport. The patient compartment offers high-end padding and bright lighting from top to bottom to ensure a safe, comfortable work environment for you and your crew.



### BODY

**Headroom:** 72" floor to ceiling.

**Flooring:** Non-slip Lonplate II flooring with customer choice of standard colors.

**Compartments:** .11" (walls) bright finish aluminum diamond plate construction; .125" (floors) smooth aluminum sheet construction.

**Construction:** Structural members are 2" x 2" x .125" aluminum tubes at 12" on center for sidewall verticals, roof cross members, and floor cross members; sidewall skin is .125" aluminum sheet; roof skin is a .090" 1-piece aluminum sheet; floor vapor barrier is a .090" 1-piece aluminum sheet; doorjambes are formed integral in the sidewall .125" skin.

**Side Entry Stepwell:** .125" ADP single step side entry stepwell.

**Door Construction:** 1-piece, form rolled, compartment and entry doors; .125" smooth aluminum construction incorporating 24 bends to form a minimum 2.75" thick

door profile; doorjambes have a total minimum thickness of 1/4" for door and hinge attachment; doors are mounted with stainless steel 1/4" x 3/4" torx head screws; door hinges are polished stainless steel with 1/4" stainless pin; door hinges are slotted for convenient adjustment; pressure sensitive door seals installed on the outer door pan flange; recessed interior door liner with three access points for servicing latches; 3-piece door liners are provided for all entry doors; Tri-Mark heavy-duty locking paddle handles with 2-point double latching on compartment and entry doors.

**Rear Step:** Diamond back grip pattern, flip-up center section and cast aluminum Medtec logo endpods.

**Rubrails:** All aluminum C-channel style rubrails.

**Windows:** 1 - 18" x 19" sliding tinted glass window in side patient entry door; 1 - 18" x 19" fixed tinted glass window in each rear patient entry door.

### CHASSIS

International, Freightliner

170" x 96" Conversion  
Body Style A or B



In a nutshell, the AD-170 is a rock-solid ambulance, built for the way your crew likes to work.

### EMERGENCY LIGHTS

**Intersection Lights:** 2 Whelen 400 series halogen lights with red lenses.

**Front Lightbar:** 58" with customer choice of lens colors; 1 on/off switch in the front console.

**Load Lights:** 2 Opti-Scene 8° - 32° lights located above the rear doors; activate in reverse; 1 on/off switch in the front console.

**Scene Lights:** 4 Opti-Scene 8° - 32° lights, 2 per side; separate on/off switch in the front console for each side.

**Siren:** 200 watt remote siren located in the front console; 1 siren/horn selector switch in the front console.

**Speakers and Lights:** Speakers mounted under the bumper; 2 Whelen 700 Series halogen forward-facing lights with red lenses.

**Warning Lights:** KKK lighting with E-Spec flash pattern; 8 Whelen 900 Series halogen lights with red lenses; 1 Whelen 900 Series halogen light with clear lens (cancels in secondary mode); 1 Whelen 900 Series halogen light with amber lens (flashes in secondary mode); front clear light and rear amber light flash together with intersector and speaker lights. LED stoplights and taillights, and halogen backup lights are standard.

Medtec packs the AD-170 with design and safety features to help you do your job better than ever. Double-panel doors with recessed liners, sweep-out compartments, easy-access storage and optional fold-down safety steps give you a solid, safe ambulance that's custom-built for the way your crew likes to work.



### OXYGEN/VACUUM

**Oxygen and Vacuum Outlets:** 2 oxygen outlets and one vacuum outlet in the primary action area.

**Oxygen Cylinder Mount:** Adjustable stainless steel rings for M-size cylinder, located in the streetside front compartment.

**Vacuum and Suction System:** Thomas brand vacuum pump in streetside intermediate floor compartment 1 on/off vacuum switch at rear console; aspirator with disposable canisters mounted on action wall.

### CABINETS AND HARDWARE

**IV Holders:** 4 recessed IV holders with Velcro® straps — 2 over cot and 2 over squad bench.

**Technician's Seat:** High-back captain's chair with left-side armrest and swivel base; EVS Vac-formed upholstery.

**Cabinets:** Flip-up and sliding doors; roll-out writing tray with storage underneath flip-up Plexiglass lid; adjustable shelves; sealed interior corners for easy clean up; cabinet faces have picture-framed windows with mitered corners; tinted acrylic (Plexiglass) doors; full-length extruded aluminum pull handles on sliding glass doors; 5" rounded safety corners.

**Squad Bench:** Seamless vacuum-formed cushions and upholstery, split lids with storage below; gas-prop style hold opens (lid automatically opens when latch is released); stainless steel paddle latches in the face of the bench to hold the lids closed in the event of an accident; three seatbelts for seated and supine positions.

### ELECTRICAL

**Alternator:** (See chassis specifications.)

**Circuit Board:** Self-diagnostic module power distribution printed circuit board with automatic reset circuit breakers; a complete set of each size relay and circuit breaker is mounted in the electrical cabinet.

**Heat/Cool:** A combination heating and cooling unit installed over the walk-through or pass-through window with 3-position mode selector switch and thermostat on rear control panel. (Ducted Heat/Cool with ceiling vents optional.)

**115-Volt Outlets:** 3 - 115-volt hospital grade duplex outlets with GFI protection — 1 in the primary action area, 1 in the second action area, and 1 in the ALS cabinet.

**Shoreline:** 115-volt 20 amp twist-lock power inlet with watertight cover; pigtail extension with twist-lock and standard 3-prong ends.

**12-Volt Outlets:** 2 cigarette-style outlets — 1 in the primary action area and 1 in the ALS cabinet; Schottky diode to isolate medical equipment.